

COLONIAL

PERFORMING ARTS CENTER

100
years!

1924-2024

2024-2025 SEASON



Celebrating 51 years in Keene! We are locally owned and employ local people. Visit our showroom and present this playbill for \$495 off your heat pump or solar installation (valid through 6/30/25).



Go Heat Pumps. Go Solar.
GoBergeron.com
(603) 563-8305



Dear Friends,

Welcome back to the Colonial Performing Arts Center's 100th Anniversary Season!

We have had an interesting start to this historic milestone year and can't wait for you to enjoy our full program for this season. We will be offering a wide range of options for you, including music, dance, comedy, theatre, and cultural presentations.

There will be something for everyone, from multi-platinum singers Andy Grammer and Josh Turner to comedian Lewis Black in his final tour to A Charlie Brown Christmas - Live on Stage. We also continue the Met Live in HD series, our impactful student programming, and much more.

We agree with our patrons when they tell us the Colonial is a fun and safe place to escape the pressures of day-to-day life. A place where you can relax, laugh, sing, and enjoy the company of others who love live music and theater.

We are delighted at the community's response to our new front-of-house area and the improvements to the stage area through our recent major renovations. Also, our second venue, SHOWROOM, directly behind the main theater, continues to host local, national, and emerging artists of many genres.

To everyone who has attended a performance, joined as a member, or donated over the years, we deeply appreciate you being a part of the Colonial family. Your support positively impacts the Colonial and the community we serve.

You make what we do possible. Thank you!

We look forward to welcoming you and your friends as we continue to celebrate 100 years of entertainment and enrichment!

Tom Minkler

*Next Act Capital Campaign, Chair
Colonial Board of Directors, member & former Chair*



C&S Family of Companies and Visory are proud to be Season Underwriters and invite you to share in their support of the Colonial Performing Arts Center.



SEPTEMBER

- IT'S BRITNEY! KEENE PRIDE TRIBUTE SEPT 7
- AJ CROCE - CROCE PLAYS CROCE SEPT 13
- 50TH ANNIVERSARY TOUR
- ANDY GRAMMER: GREATER THAN - A ONE MAN SHOW SEPT 15
- LEWIS BLACK: SEPT 20
- GOODBYE YELLER BRICK ROAD, THE FINAL TOUR!
- HARRISON GOODELL AND JAKE SWAMP & THE PINE SEPT 20
- (at SHOWROOM)
- GOLDENOAK (at SHOWROOM) SEPT 27
- JOSH TURNER - THE GREATEST HITS TOUR SEPT 29

OCTOBER

- CLASSIC ALBUMS LIVE - BEATLES: ABBEY ROAD OCT 5
- ZACH NUGENT'S DEAD SET OCT 11
- BRIAN GLOWACKI (at SHOWROOM) OCT 12
- MAGIC ROCKS! ILLUSIONIST LEON ETIENNE OCT 18
- MET LIVE IN HD: JEANINE TESORI, OCT 19
- LIBRETTO BY GEORGE BRANT GROUNDED
- THE SWEET CAROLINE TOUR OCT 26
- FEATURING JAY WHITE
- MET LIVE IN HD: JACQUES OFFENBACH LES CONTES D'HOFFMANN OCT 26
- MR AARON BAND - FAMILY HALLOWEEN BASH OCT 27
- (at SHOWROOM)
- ROCKY HORROR PICTURE SHOW OCT 30

NOVEMBER

- GET THE LED OUT NOV 1
- BRUCE COCKBURN NOV 2
- AYSANABEE (at SHOWROOM) NOV 7
- THE GILDED STAGE - FALL GALA NOV 9
- PETER YARROW & NOEL PAUL STOOKEY NOV 15
- JUSTON MCKINNEY NOV 16
- MUTTS GONE NUTS NOV 17
- ADDISON AGEN (at SHOWROOM) NOV 22
- PINK TALKING FISH NOV 23
- MET LIVE IN HD: GIACOMO PUCCINI TOSCA NOV 23

SEASON AT A GLANCE

SHOWS ADDED FREQUENTLY!

Sign up for our email list to stay in the loop.
THECOLONIAL.ORG



DECEMBER

NEW YORK THEATER BALLET'S *THE NUTCRACKER*
SCOTT BRADLEE'S POSTMODERN JUKEBOX
THE 10TH YEAR ANNIVERSARY TOUR
LOW LILY (at SHOWROOM)
MET LIVE IN HD: WOLFGANG AMADEUS MOZART *MAGIC FLUTE*
A CHARLIE BROWN CHRISTMAS - LIVE ON STAGE

DEC 7
DEC 13
DEC 13
DEC 15
DEC 28

JANUARY

MET LIVE IN HD: GIUSEPPE VERDI *AIDA*

JAN 25

FEBRUARY

KEENE LIONS CLUB MUSICAL

FEB 7-9

MARCH

HYPROV: IMPROV UNDER HYPNOSIS
STARRING COLIN MOCHRIE AND ASAD MECCI
NATALIE MACMASTER & DONNELL LEAHY
MET LIVE IN HD: LUDWIG VAN BEETHOVEN *FIDELIO*
PETER ANTONIOU (at SHOWROOM)
MOONDANCE
SONS OF MYSTRO (at SHOWROOM)
AN EVENING WITH DAVID SEDARIS

MAR 1
MAR 14
MAR 15
MAR 21
MAR 22
MAR 22
MAR 30

APRIL

EVIL WOMAN - THE AMERICAN ELO PRESENTS:
THE ELECTRIC LIGHT ORCHESTRA EXPERIENCE
DRAGONS AND MYTHICAL BEASTS
APPLE HILL STRING QUARTET
ONE NIGHT OF QUEEN
MET LIVE IN HD: WOLFGANG AMADEUS MOZART
LE NOZZE DI FIGARO

APR 4
APR 5
APR 13
APR 17
APR 17

MAY

MET LIVE IN HD: RICHARD STRAUSS *SALOME*
MET LIVE IN HD: GIOACHINO ROSSINI *IL BARBIERE DI SIVIGLIA*

MAY 17
MAY 31



OUR MISSION:

**ENGAGE.
INFORM.
EMPOWER.**

**We believe that information is power.
The power to make for a better community.**

Celebrating our 225th year of serving the community.



Support local journalism with your su

The Keene Sentinel is a proud supporter of the arts and The Colonial Theater. We are grateful for their contributions to the enrichment of our communities.

er.
community

scription.



225
YEARS
THE KEENE SENTINEL
ESTABLISHED 1799

COLONIAL THEATRE CAST

ADMINISTRATIVE STAFF

CRICKET VAN ALSTYNE
Administrative Manager

ELISE DEARTH
Audience Experience
Manager

MARTHA HAAS
Director of Marketing
& Communications

BRITTA HALLBERG
Director of Operations

SAM MATHEWS CLARK
Director of Development

OWEN MURPHY
Director of Production

VICKY PITTMAN
Director of Education &
Community Engagement

GREG PREGENT
Rentals Manager &
Lead Projectionist

STAFF

Dakota Adams
Theresa Adams
Zoey Ash
Samantha Brault
Caitlen Brown
Jose Chajon Porix
Ellis Chase-Pinkney
Cedar Cleaves
Benjamin Croteau
Kurt Daniels
Gerald Davis
Randy Filiault
Jack Hanrahan
Sarah Hope

Ralph Jernberg
Madigan Keating
David LaCoste
Hannah Louder
Cybelle Mandell
Daniel Moore
Catherine Morosan
John Mousseau
Adrianna Petrillo
Kevin Postrech
Megan Quinn
Korbin Rasmus
Clement Record Jr
Joseph Reppucci

Janet Richards
Joy Richards-Davis
Chris Russell
David Small
Brian Smeltz
Owen Steelman
Andrew Tarnowski
Keith Thibault
Mark Wadsworth
Sophia Wallace
Connor White
Royce Witham
Lydia Wright

BOARD OF DIRECTORS

We'd like to take this opportunity to provide a special thank you to our Board of Directors. They are an amazingly talented and selfless group, whose incredible commitment illustrates their investment in the work that we all do. Their passion is unmatched as they support and advocate for the Theatre day in and day out. We sincerely appreciate their service and look forward to their support as we continue to celebrate our 100th year! Thank you very much - we are so grateful for your generosity.

Heather Atwell
Emily Benson, *Vice Chair*
Adam Burke
Kathleen Burke
Peter Carvell
Carol Connare
Mark Danahy, *Treasurer*
Steve Kim

Gregg Kleiner, *Secretary*
Randyn Markelon
Pamela Melvin
Tom Minkler
Christopher Pong, *Chair*
Armando Rangel
Tara Sad

TABLE OF CONTENTS

1
WELCOME TO THE
2024-25 SEASON

2-3
2024-25 SEASON
AT A GLANCE

6
STAFF

8
ABOUT THE COLONIAL

15-17
THE NEXT ACT CAPITAL
CAMPAIGN DONORS

23-27
2024-25 SEASON
INDIVIDUAL MEMBERS

31
A BRIEF HISTORY

32-33
CELEBRATING 100 YEARS

34
FOUNDATION
& OTHER SUPPORT

36
MET LIVE IN HD 2024-25

42
CORPORATE MEMBERSHIP

43
2024-25 SEASON
CORPORATE MEMBERS

48-49
THE COLONIAL
VOLUNTEER USHERS

51
EDUCATION AND OUTREACH
SEASON AT A GLANCE

52-53
EDUCATION AND COMMUNITY
ENGAGEMENT PROGRAM

54
ARTS ADVOCACY

56
NOTABLE PERFORMANCES

62
BOX OFFICE INFORMATION

63
EMERGENCY EVACT INFO AND
BUY YOUR TICKETS THROUGH
THE COLONIAL

64
INDEX OF ADVERTISERS

COLONIAL
PERFORMING ARTS CENTER



MISSION

The Colonial Performing Arts Center is a historic performing arts center, which brings the cultural and creative spirit of our community to life.

VISION

The Colonial Performing Arts Center will be the model regional performing arts center; exciting, educating and challenging audiences of all ages.

ABOUT THE ORGANIZATION

The Colonial Performing Arts Center is a nonprofit organization typically entertaining more than 50,000 patrons annually (including thousands of school children), with acclaimed film, music, theater and dance performances at two venues. The historic 900-seat theatre, opening in 1924 and undergoing a major restoration in the 1990s, was named to the New Hampshire State Registry of Historic Places in 2004. A second round of major renovations was completed on the historic theatre in 2021, expanding the lobby area and adding functionality to the stage and rigging. The adjacent building for the new second venue, SHOWROOM, was purchased and renovated in 2020/2021.

Pursuing its vision to “be the model regional performing arts center; exciting, educating and challenging audiences of all ages,” the Colonial Performing Arts Center presents diverse and relevant programming, including its trademark live performance series, award-winning films, and innovative community outreach programs. Additionally, the organization plays host to numerous community events for the benefit of over a dozen local nonprofits each year.

A cultural anchor in the regional economy, the Colonial Performing Arts Center and its patrons contribute more than \$4 million annually to the local economy through show and visitor-related spending during an average season.

For more information, visit TheColonial.org.



Film.



Drama.



Music.



**Proud to support The Colonial Theatre
and the local arts.**

- Auto ● Home ● Umbrella ● Life ● Health
- Business Insurance ● Group & Employee Benefits

**CLARK
MORTENSON**



Hilbgroupne.com

102 Main St, Keene, NH 03431 ● 603-352-2121

Makers of high quality tools for weaving and knitting enthusiasts, including looms, woolen-spun yarns, custom spinning, and workshops.



HDHarrisville Designs

RETAIL STORE & STUDIO

Open Tues-Sat, 8:30-5:30 4 Mill Alley, Harrisville, NH 603-827-3996 harrisville.com



Norm's
SKI & BIKE SHOP
Your Pro Shop For The Whole Family!

62 Martell Ct., Keene NH 03431
603-352-1404 | contact@normsskibike.com
www.normsskibike.com



Keene

PRIDE



Keene Pride Week

9/7/24-9/15/24

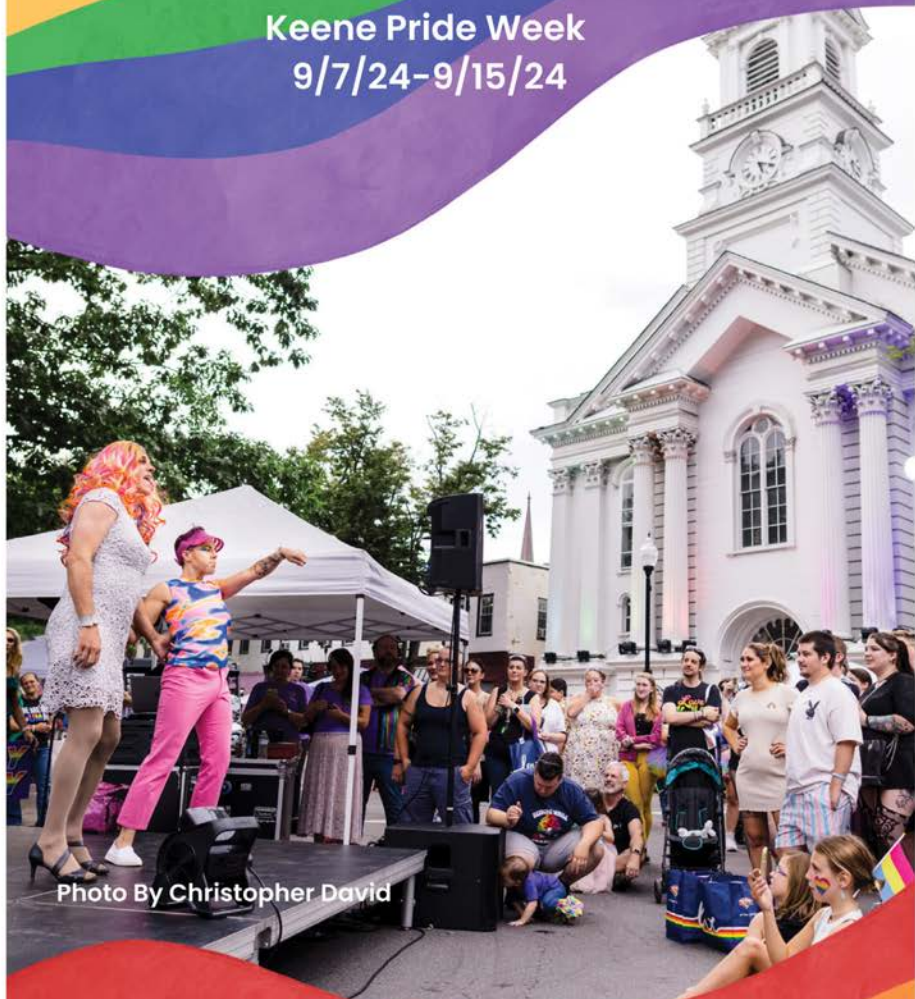

Photo By Christopher David

Bringing the LGBTQ+ population together with
community building events all year long.

www.keenepride.org

THE TOADSTOOL BOOKSHOPS

"Enchanting selections of wonderful books and music"



12 Emerald St. • Keene, NH 03431

603-352-8815

12 Depot Square • Peterborough, NH 03458

603-924-3543

And online at toadbooks.com

Where you can see what's in stock at our stores, what's available to order, & you can download e-books for many types of e-readers

Looking for Affordable Office Space?



Welcome to...
The Silk Mill
PROPERTY

Keene's
BEST KEPT SECRET
in affordable business
office space!



✓ Office space rentals start at \$350/month and include:

- heat/hot water
- snow/trash removal
- high-speed Internet
- ample FREE on-site parking
- loading dock
- ADA compliant elevator to second floor

✓ Perfect for start-ups or as incubator space

✓ Spaces range from 300 to 7,000 square feet

✓ Walking distance to downtown Keene

✓ Common area maintenance charges are FREE for the life of your lease

For more information and a tour of available office spaces please contact:

TOUSLEY
PROPERTY MANAGEMENT LLC

Big or small, space for all!
160 Emerald Street, Keene, NH 03431 • 603-352-9071
info@tousleyproperty.com

www.tousleyproperty.com



Committed to Excellence



The Best Roofs Under The Sun

ClassicMetalRoofingSystems.com



603-880-1809

DonaghueConstruction.com

Reasons to Support the Arts

ARTS STRENGTHEN THE ECONOMY

The arts & culture sector - nonprofit, commercial, education - is a **\$1.02 trillion industry** that supports **4.9 million jobs** (2021).

The arts represent **4.4% of the nation's economy** - a larger share of GDP than agriculture, transportation, and construction.

The arts have a **\$17.8 billion** international trade surplus.

@artsactionfund
@americans4arts

Provided by AmericansForTheArts.org.



For all your special occasions



**Adventure Limousine
and Transportation**

603-357-2933

877-ADV-LIMO advlimo.com

MoCo Arts is a family centered nonprofit arts education organization located in downtown Keene offering classes in dance, theatre, and multi-arts summer & vacation camps for students ages 6 months through 18+ years.



Tap | Jazz | Hip Hop | Ballet | Modern

- Beginner through advanced
- Select classes for adults!
- Costumes included for all performances
- No hidden fees!

Musical Theatre & Straight Plays

Questions? Email us at info@moco.org.

Check out the full class schedule at moco.org/class-schedule.

Ask us about tuition assistance!



CREATE

AN EXTRAORDINARY
SPACE

MARVIN 

OFFERING COVERAG
THROUGHOUT ALL OF
NEW HAMPSHIRE
NASHUA | SWANZEY
603-965-2320

MILLWORK MASTERS



MILLWORKMASTERS.COM

Anonymous (25)	Jill and Don Brehm	Alan Conklin	The Eppes-Jefferson Foundation, Inc.
Abigail Abrash-Walton and Matthew Walton	Karen Brook and Beth Sebring	Cathy Conkling and Richard Meyer	Barbara and Lucius Evans
Joan Ames	Barbara Bryce and Tom Julius	Patti and Michael Conway	Eversource Energy Foundation
Earl Anderson and Gareth Williams	Sally and David Bulger	Andrew and Pamela Cooke	Caroline and Tom Ewing
Ann Henderson Interiors	Kathleen Burke and David Zimmerman	Corning Incorporated Foundation	EZ-CRETE, LLC
Ashuelot River Hydro, Inc.	Rand and Jayne Burnett	Tom Crouse and Kay Enokido	Ms. Patty Farmer
Athens Pizza House	Jim Butterfield and Chris Brunner	Maureen Curtiss and Dean Beaman	Susan Farrell
Catherine Atkinson and Ed Snyder	Susan Byrne and Dr. Robert Westlake	D'Alessio & Associates Inc.	Anne Faulkner and Robert King
Ashok Bahl and Mary Przywara	C&S Wholesale Grocers	In Honor of Pat D'Ambrosio	Mary Anne and Patrick Fenelon
Bill and Kathy Baldasaro	Joe and Donna Calabro	Mark and Phoebe Danahy	Fenton Family Dealerships
Eleanor Ball	Jack Calhoun and Beth Healy	Joseph Darby and Lisa Russ	The Ferrando Family
Robert Ball and Zanna Elliot	Patricia Campbell and David La Coste	Davis Oil Company, Inc.	Filtrine Manufacturing Co.
David and Fay Barden	Alan and Patricia Cantor	Deborah DeCicco	Russ and Kathy Fleming
Judy Barden	Don and Heidi Carlisle	P Michael and Deborah S Degan	Foard Panel
Adrian Basora and Pauline Barnes	Carlisle Wide Plank Floors	Mimi and Pete Delaney	Katie Folts and Ryan Czekanski-Moir
Mr. Philip Bastedo	Kim and Lorilyn Caron	Barbara and Carl DeMatteo	George Foskett and Mary Delisle
Stephanie and Joseph Baute	Barb and Bill Chase	Julie C. Dickson and Jay Smeltz	Eve Fox and Tom Lewis
Jill Beam	Kathleen and Michael Chelstowski	John and Jean Diamond	Margaret Foxweldon and Len Weldon
David and Patricia Beffa-Negrini	Kathleen Chertok and Peter Bonneau	Bob and Els Dignitti	Beth and Bill Franzen
Deanne Belanger	Cheshire County	Douglas Co. Inc.	Frazier & Son Furniture
Judi and Bruce Bellows	Linda Chimiielewski	Eve A. and Alec Doyle	Kathy and Herb Frink
Dan and Nancy Belluscio	Mike and Betty Christiansen	Sue Doyle	Mark and Amanda Fryberger
Dean Bennett	Ms. Eloise Clark	Michael Duffin	The Fryberger Family, in Memory of Molly Geraghty
Carolyn Benthien	John Craig Clark and Judy Unger-Clark	Diana Duffy	Mark and Alice Funk
Ms. Lucia Bergeron	Clark-Mortenson Insurance	Patricia and Richard Dugger	G&H Keene
Bergeron Construction Co., Inc.	Robert and Tere Clarkson	Andrew E. and Hallie L. Dugrenier	Ann M. Gagnon
John and Alice Bernet	Margot P. Close	Dunkin'	The Galbraiths
Stephen and Patricia Bianco	The CMH Foundation	Beverly Dwight	Glenn and Abigail Galloway
Greg Blair and Kathi Borden	Russ Cobb and Brett Amy Thelen	Thomas R. Eaton	Katie Gardella and Peter Straus
Michael and Kathryn Blair	Jarvis Coffin	Lisa and Bill Edwards	Maich Gardner and Ed Tomey
Richard Block	Cogswell Benevolent Trust	The Edward Jones Office of Ely Thayer	Alan and Sandi Gaspardino
Mark Bodin	Pete and Mary Comerford	The Edward Jones Office of David Therrien	Barbara and Mark Gavin
Dwight and Debra Bowie	Communicators Group	Bob and Norma Elliott	Michael Genest and Kathleen Brennan
Alan and Judith Boyer	Jim and Erin Condap	Seth and Nancy Emont	Rosemary Gianni
Mr. and Mrs. Bradshaw	Marina and Joseph Coneeny	Dita and Bob Englund	
Stephen B. Bragdon and Cheryl A. Belair			

Chris Gilmenakis	John A. Hubbard	Jean and Robert Kostick	Anne and Bill Meddaugh
John and Eileen Glover	Dr. Philip Cate Huckins	Barb and Paul Koutras	The Meehan Family
Cecile Goff	Judy and Phil Hueber	Michael and Jenny Krinsky	Mark Meess and Anne Shedd
Good Fortune Jewelry & Pawn	Dennis and Evelyn Huston	Laura Kucharczyk	The Melanson Company, Inc.
Bryan and Mary Granger	Bert Inman & Lorie Rogers	Lab'n Lager Food and Spirits	Allen and Ellen Mendelson
Carl and Karin Gravina	The Insurance Source	Tad and Linda Lacey	Dean and Debbie Merrill
Douglas and Julie Green	Mark and Susan Irvings	Walter and Barbara Lacey	Merrill Family Charitable Foundation, Inc.
Nathanael B. Greene, Jr.	Ruth and Carl Jacobs	Karoline and Don Ladd	Diane and Mike Metell
Mitchell and Erika	Peter Jenness Family	Artie and Kristina Lang	Don and Jackie Metivier
Greenwald and Family	Evan John and Theresia Weber-John	Michael and Diane Langlois	Tom and Lisa Migneault
Kathy and Mark Gross	John G. Burk & Associates, Cpa's P.C.	Jeffrey Lapid	Miller Orthodontic Specialists
Jennie and Steve Gryczka	Harry H. Johnson, Jr.	Jane and Steve Larmon	Jeffrey Miller and Carol MacKinnon
G.S. Precision	Karen Johnson	Marion Lefrancois and Kelly Dodge	Nancy Miller
Dr. Robert and Dr. Sherry Guardiano	Nancy Johnson and Don Caruso	Marcia Legru	Mitronics Manufacturing, Inc.
Richard and Anne Guerriero	Ken and Carol Jue	Sheila and Charles Lennon	Tom and Heather Minkler
Linda Guinane	Cheryl and Jay Kahn	Charlotte and David Lesser	Geoffrey and Donna Molina
Dayna Guldhauge	Melany Kahn and Bo Foard	Maryann Lacroix Lindberg	Monadnock Ford
Fred and Christine Hadlow	Judy and Rich Kalich	Lesley Loke and Liam Kelly	Mary Louise and Charles A. Montgomery, Md
Heidi and Jeff Halford	Basilio Kalpakian	Susan and Peter Longsjo	Montshire Pediatric Dentistry PC
Jim and Nancy Hall	Larry and Ashton Kane	Honey Loring	Greg Moore
Hamblet Electric, Inc.	Kapiloff Insurance Agency	Luca's Mediterranean Cafe	Moore Nanotechnology Systems, LLC
Hamshaw Lumber	Karl and Roxanne Karter	Frank Lucius Construction, LLC	David and Donna Morse
Sarah Handford	Margaret Kasschau	Karen and C. Robert Lyle	Bill and Anne Moyle
Jennifer M. Hanrahan	Arthur Katz	J. Lyon	M&T Charitable Foundation
George Hansel	The Kayser Family Fund of the New Hampshire Charitable Foundation	Kip and Sandy Mackenzie	Caroline Muir
Peter and Bridget Hansel	kcs Architects	C&D MacVeagh	Pam Murphy
Nancy and Roger Hansen	Lynne and Mike Keating	The Madeline G. Von Weber Trust	Tom Murray and Linda Cates
Lorna Harling and Susan Crim	Matt and Karen Keenan	Martin and Barbara Mahoney	Margaret Murtha
Thomas and Anne Havill	Keene Auto Body	Making Community Connections Charter School	Robin and Philip Nachman
Jaclyn Headings and Family	Keene Chrysler Dodge Jeep	Gail Malitas and Bill Robbins	Susan Nadeau
Joyce and Donall Healy	Keene Eye Care	Pete and Sharon Mangan	Nathan Wechsler and Company, PA
Daniel Henderson	The Keene Sentinel	Mick and Lizzy Marsden	Network for Good
The Heneghan Family	Keene Signworx	Chris Marseilles	Tom and Carol Newcombe
Charles H. Henry, DDS	Risa and Doug Keene	Mascoma Bank	
Ken and Melissa Herman	The Kidder Family	Mascoma Bank Foundation	
Bill Heyman and in Loving Memory of Peggy Heyman	The Kidder Smith/Smith Family	Craig and Sylvia McBeth	
Hoefer Family	Joslin Kimball Frank	Ann and Timothy McCann	
Hoffman Family Foundation	Maya King	Greg and Sue McConahey	
Patricia G. Hoffman	The Kingsbury Fund	Kevin and Wendy McDonnell	
Dr. and Mrs. Stephen Hoffman	Alan and Anita Kintisch	Marianne and John McGauley	
Cherie Holmes and Yvonne Goldsberry	Gregg Kleiner	Susan and John McGinnis	
Don and Cindy Holshuh	Lincoln and Gweneth Kolodziej		
The Houston Family	In Memory of Catherine Joy Koontz		



Susan and Jeff Newcomer	Putney Self Storage	Linda Singer and Greg Rothman	Newell and Cheryl Tolman
New Hampshire Charitable Foundation	Judith Putzel	Stella Sise	Elizabeth Tong
New Hampshire Trust Company	Erika Radich and Len Fleischer	Richard and Louise Slayton	Robert Tortolani
NGM Charitable Foundation	Dan and Louise Rath	Mandy and Jason Sliver	Bob and Dilly Trebilock
New Hampshire Community Development	Jason and Stephanie Raynor	Nancy J. Sloan	Tree-Free Greetings
Finance Authority	RE/MAX Town & Country	Jason and Christine Smart	True North Networks
Don Nieratko	Brian and Reinetta Reilly	Jay Smeltz and Julie Dickson	Gill Truslow
John and Catherine Northcott	Michael Remy	Marcy and Chip Southgate	Turmoil Manufacturing Company
Northeast Delta Dental	The Richards Group	Jane and David Stabler	Bill and Kris Tyson
Norton & Abert PC	Patrick and Katherine Richardson	The Stage Restaurant	Vanguard Charitable
Sandra and Howard Nottingham	Kathleen and Larry Robbins	Jonathan and Valerie Starbuck	Paul and Ruth Venezia
Dean and Kathy Ogelby	Ann and James Robinson	C. and V. Steadman	Nancy and Paul Vincent
Judith E. and Anthony L. Olson	Butch and Eva Roeder	Joseph D. Steinfield	Janice Walker
Julia Pakradooni and David Kennard	George and Julie Ross	Betsy Street	Rich Wallace and Sandra Neil Wallace
Charles Palmer	John Round	Craig Stockwell and Sarah Jane Mustin	Pamela and Ken Walton
The Panjandrum Foundation	Sharon and Jim Rousmaniere	Alan and Melissa Stroshine	Cynthia and Mike Waters
Pappas Contracting	Marc and Amy Roy	Bill Stroup and Amy McIntyre	Kevin and Heather Watterson
Ted and Ruth Parent	Daryl and Patricia Royce	Jeanie M. Sy	Richard and Susan Way
Rosaleen and Joe Parisi	Jeff and Linda Rubin	Cathie and Jim Talbert	Cynthia and David Westover
Park Place Veterinary Hospital, Pllc	Danielle and Anthony Ruffo	Richard Talbot	Eric and Jenn Weisenberger
Ms. Deborah Parker	Tara Sad	Roe-Ann and John Tasoulas	Larry Welkowitz
Richard and Lisa Pearl	Lisa and Eric Sandstrum	Mr. and Mrs. Peter Tavolacci	Welnak Dental PC
Sandra Phipps	The Sarson Family	Cameron Tease	Julie White
Tobee Phipps	Savings Bank of Walpole	Maria and Kim Temple	Liane Wiley and David Berry
Ms. Sandra C. Pierre	Arnold Scadova and Arlene Edes	Julie and Gregg Tewksbury	Marilyn Wilking
Leslie and Jane Pitts	Koo and Jeff Schadler	Thai Garden Restaurant	Terrence Williams
Vicky Pittman and Michael Kulp	Connie and John Schlegelmilch	Kathy and Jon Thatcher	Donald V. and Kathy T. Wilson
Pizza Pie	Judy and Anton Schoolwerth	Ely Thayer	Wilson Orthodontics
Kelsey Plifka and David Harris	Tad Schrantz and Jan McGonagle	David and Lisa Therrien	Thomas and M. Christine Winmill
Lori and Stan Plifka	R.E. Schultz	Robert and Lianne Therrien	Mark and Sharon Wirant
Terri Plifka	Michael and Patti Schuman	Denise Thomas	Ellen M. Wishart
Peter Poanessa	Schwab Charitable Fund	Linda Thomas	The Witkowski Family
Christopher and Michelle Pong	Scully Architects	Lynn M. Thomas	Patricia and Michael Witthaus
Dr. Charles Post and Elissa Zengel	Ed and Joan Selby	Annie Thompson and Joy Ellis	Tim and Cindy Wollaeger
Prime Roast Coffee Co. LLC	Servpro of Keene, Inc.	Rod and Nancy Thompson	Wonder Casino
Putnam Foundation	Greg Seymour	Laurie and Mark Tigan	Kevin and Cindy Woolley
Jim and Judy Putnam	Jane and Gary Shapiro	Timken Foundation of Canton	The Works Bakery Café
Lori and Bill Putnam	Mary Sherwin	Gary and Susan Tochterman	Jack and Aylene Wozmak
Tom and Barbara Putnam	Mark and Barbara Silbey		Ye Goodie Shoppe
	David Shonk		Louise Zerba
	Lynn and Art Simington		

CELEBRATING 100 YEARS OF ENTERTAINMENT IN DOWNTOWN KEENE

MAIN STREET, KEENE, NEW HAMPSHIRE

2782





Tell Us Your Stories!

Help us celebrate 100 years of enriching and entertaining the Greater Monadnock Region. What was your favorite movie at The Colonial? What really cool show did you see here? Did you have a romantic date in our beautiful old theatre? Did you have a date gone wrong?

We'd love to hear all about it. And we'd love to share all of these stories in celebration of our grand birthday.



thecolonial.org/about-us/story/

Thank You!



**STEELMAN PRODUCTION
SERVICES INC.**

Proud Sponsor of the
COLONIAL THEATER

steelmanproductions.com

LIVE EVENT PROFESSIONALS

We manage every event professionally and safely, with discretion, and an eye on all the details. Our team includes runners, stagehands, electricians, carpenters, equipment operators, steel workers, riggers, stage managers, production managers, caterers, artist relations, and payroll accountants.





BADGER®

CULTIVATE GOOD

**Proud
Supporter of
The Colonial
Theatre**

**CERTIFIABLY
GOOD**

Certified



W.S. Badger Company, Inc. 768 Route 10, Gilsum, NH 03448
603-357-2958 • badgerbalm.com

-Since 1952-

**The Finest Selection of
Leather Apparel & Gifts**



Moccasins
Coats • Jackets
Hats • Belts
Handbags
Gloves
Big & Tall Sizes
Western Boots
Motorcycle
Apparel
Jewelry & Gifts



**Howard's
Leather**

There's Nothing Like Real Leather

1651 Rte. 9, Spofford, NH 03462

603-363-4325

howardsleathernh.com



Mon.-Sat. 9:30am-5:30pm; Sun. 11:30am-5:30pm



kcs ARCHITECTS

(603) 439-6648

katie@kcs-architects.com

KORVIN

APPLIANCE



Your Hometown Appliance
Store Since 1976

- Frigidaire • Whirlpool • Maytag
- Electrolux • Kitchenaid • Bosch

65 Roxbury St., Keene • 352-3547 • www.korvin1.com



APPLE HILL CENTER *for* CHAMBER MUSIC



Playing for Peace™

Apple Hill exists to create, perform, and teach chamber music at the highest standard, and cultivate connection and understanding among people of diverse backgrounds and cultures.

THE APPLE HILL STRING QUARTET • CONCERT SERIES
EDUCATIONAL PROGRAMS • SUMMER WORKSHOP
PLAYING FOR PEACE™ PROGRAM

410 Apple Hill Road | Nelson, NH 03457 | 603-847-3371 | www.applehill.org

**JOIN OR RENEW
TODAY!**

**ENSURE OUR FUTURE
THRU MEMBERSHIP**

BECOME A MEMBER OF THE COLONIAL!

Your membership supports us in presenting an exciting and diverse mix of events and outreach activities at affordable prices. Join, renew or upgrade your membership today! Membership starts at \$50 and is valid for an entire calendar year.

Benefits vary and may include:

- Advance ticket notice and sale
- Discounts on tickets for live events and film
- Ticket Exchange Privileges
- Invitation to exclusive recognition events and more

**For more information contact
Sam Mathewes Clark
sam.clark@thecolonial.org**

**FOR A COMPLETE LIST OF MEMBER BENEFITS,
visit thecolonial.org**

INDIVIDUAL MEMBERS

PLATINUM

Ashok Bahl and Mary Przywara
Guinane Family
Judith Putnam
Judy and Jim Putnam
C. and V. Steadman

GOLD STAR

Parker and Sally Hansel

ANGEL

Bill Heyman
Larry and Ashton Kane

BENEFACTOR

Geoffrey Alexander
Dr. Patricia Campbell and
David La Coste
Michael and Elizabeth Christiansen
John Craig Clark and
Judy Unger-Clark
Mark and Phoebe Danahy
Elizabeth and William Dewey
Margaret Foxweldon and Len Weldon
Glenn and Abigail Galloway
Yvonne Goldsberry and Cherie Holmes
Dr. Robert and Dr. Sherry Guardiano
Thomas and Anne Havill
Daniel Henderson
Tom and Lisa Migneault
Tom and Heather Minkler
Tom Murray and Linda Cates
Joseph and Rosaleen Parisi
Bryan and Jennifer Rudgers
Eileen and Michael Sarson
Julie and Gregg Tewksbury
Gerard Waters and Janet Bisson
Berton and Lynne Wilkins
Tad Schrantz and Leslie Lazarus

PATRON

Heather Atwell
David and Holly Barrett
Jill Batty and Daryl Stutes

Pierre Bonneau
John Bunce
Peter Carvell
Karen Clement and Richard Jordan
Jim and Erin Condap
Carol Connare
Elise Dearth
Peter and Irene Friedrichs
Maich Gardner and Ed Tomey
Mary and Bryan Granger
Britta Hallberg
Dr. Roger and Nancy Hansen
R. Blair Heise II
Barbara Henderson
Harry H. Johnson, Jr.
Alan and Anita Kintisch
Martha and Michael Ladam
Jeffrey Lapid and Susan Abraham
Tonya and Jonathan Marshall
Steve and Linda Myers
Dr. Jeffrey and Susan Newcomer
Jim and Karen Nickerson
Norma Jeanne Pinney
Christopher and Michelle Pong
Butch and Eva Roeder
John Round
Arnold Scadova and Arlene Edes
Robert Schultz
Robert J. and Tracy Shalit
David and Jane Stabler
Dr. Kimball and Maria Temple
Nancy and Paul Vincent
David Zimmerman and
Kathleen Burke

MUSE

Dr. Emily Benson
Katie Gardella and Peter Straus
Carl Goldknopf and Mary Ann Marino
Karen and Robert Johnson
Kathleen and A. Willis O'Donnell
Leslie and Jane Pitts

Dr. Kathy Reilly
Berdine and Matthew Robinson
Alice and Bruce Rokes
Mandy and Jason Sliver
Gary and Susan Tochterman
Ellen M. Wishart
Paul and Suzanne Krautmann

SUSTAINER

Patrick and Mary Anne Fenelon
Russ and Kathy Fleming
Robert and Janet Genatt
James and Lora Germain
Bruce and Nancy Graves
Nathanael B. Greene, Jr.
Jennifer and Joshua Greenwald
Mitchell and Erika Greenwald
Dr. and Mr. Steven A Gyory
Drs. Gregory and Deborah Hansen
Ruth and Carl Jacobs
Richard and Judith Kalich
Margaret Kasschau
Jean and John Keefe
Gerard and Jennifer Kiernan
Joslin Kimball Frank
Pamela and Mike Kolodziej
Michael B Lajoie
Sheila and Charles Lennon
Charlotte and David Lesser
Maryann and Robert Lindberg
David and Lisa Marazoff
Vicki Mason
Dr. Craig and Sylvia McBeth
Pam Melvin
Mary Louise and
Charles Montgomery, MD
Doug Jean Nelson
Ted and Ruth Parent
Ron and Kathy Profaizer
Judith Putzel
Sise Family
Cathy and Charles Sorenson

INDIVIDUAL MEMBERS CONTINUED

Dr. Thomas Stearns
William and Sarah Thorndike
Gill Truslow
Wayne Weil
Pamela Wilder
Miss Christine Marie Xavier
Jay and Cheryl Kahn
Margaret M Murtha

SUPPORTER

Mr. and Mrs. Daniel C. Alther
David and Vicki Bacon
Philip Bailey and Susan Roston
Gary Barnard and Carrie Goldsmith
Cecily Bastedo
Dawn Beach
Debra and Charles Beach
David and Judy Bell
Bruce and Judi Bellows
Lawrence Benaquist
Craig Bengtson and Lori LaBrie
David and Kim Bergeron
Barbara and Richard Berry
Gail A. Blair and Richard Blair
Kathryn and Michael Blair
David and Lee Borden
Mr. Adam Burke
Joseph and Donna Calabro
Steve and Diane Caswell
Kim Chaffee
Betsy Clark
Robert and Tere Clarkson

Stan Cloughly and Jennie Benoit
Daniel Henderson and Jess Codman
Daniel Cohen
P Michael and Deborah Degan
Mary Delisle and George Foskett
Mike Delpriore
Ms. Susan A. Doyle
Stephanie Droppa
Ellen Edson
Jennifer Ellison
Seth and Nancy Emont
Rebekka White Ericson and
Johnathan Ericson
Eileen Fernandes and Carolyn Crane
Martine Fiske
Denis and Karen Fortier
Mr. & Mrs. Brian Robert Fredette
Alice and Gill Fuld
Bill Gatto and Mike and
Betty Christiansen
John and Eileen Glover
Jonah and Michelle Gosnell
Bonnie Grenier
Kelly Griffin
Janet Hebert
Mr. Ryan Heilman
Frank Henderson and Claudia Taylor
Paula and Josh Hicks
Carrie and Stephen Hoffman
Brenda Howard
Bill and Sherry Huntley

Alouette and Michael Iselin
Richard and Diana Kasper
Matt and Karen Keenan
Dr. Douglas and Risa Keene
Gordon Kent
Kevin and Mary Killelea
Justin Kingsbury and Gerald &
Janet Waters
Erik and Kathy Knutsen
The Honorable Robert C Korb
Rose Kundanis and John Bordenet
Leeann Lafosse
Elaine and Lyn Landry
Fred and Dottie Lankhorst
Bob and Jackie Leahy
Jonathan Lifschutz
Peter and Penelope Lillo
John A MacLean
Chris Mahoney
Sue and Tom Masiello
Greg and Sue McConahey
The Radin Family
Chris and Victoria McIntosh
Leslie and David McLean
Denise Meadows
Bill and Anne Meddaugh
Laurie Butz-Meyerrose
Paula Miller
Marguerite Montysko
Stephanie Moody and
Megan Burke Kidder



**WE THANK
OUR
MEMBERS**

They have played
an important role
in making our
historic theatre shine

Bill and Anne Moyle
Pam Murphy
Theresa Murphy
Linda and Steve Myers
Thomas and Carol Newcombe
Carlene Newell
Christina M Niland
Jennie Norman and Bill Walker
Marcia A Parody
Paula and Larry Phillips
Hillary Prispnen
Deborah Piragis
Terri Plifka
Suelaine Poling and Bruce Myrick
Barbara Harris
Erika Radich and Leonard Fleischer
Dan and Louise Rath
Michael Remy
Allison Riley & Paul Hoffman
Patty Rocca
Pam and Bill Rohdenburg
Ron and Carol Roof
Tara Sad
Constance B. Schlegelmilch
John and Constance Schlegelmilch
Jim Schofield and Lisa Abohatab
Daniel Henderson and Caitin Selby
Edwin Selby
Mary Sherwin
Drs. Todd Silberstein and Lisa Leinua
Edward Skorupski

Jay Smeltz
Sharon Smith
Wallace and Nancy Smith
Fred and Charlene Stafford
Betsy Street
William and Sandy Swinburne
Mark and Sharon Tanzer
Jane F. Taylor
M. Bryan Terry and Robert C. Terry
David and Lisa Therrien
Jeanne Maguire Thieme and
Mike Thieme
Newell and Cheryl Tolman
Anthony and Barbara Tremblay
Lynn Tuttle
Diana Van Alstyne
Bill and Kathy Weibel
Eric Weisenberger
Eric and Kimberlee Welch
Cynthia Westover
Charlie and Faith Wilder
Liane Wiley and David Barry
Kathy Winsor and Gerald and
Janet Waters
Michael and Patricia Witthaus
Kevin and Cynthia Woolley
Charles Ferrando
CONTRIBUTOR
Robert Allen
Ron and Patty Batchelder
Jeff Bergeron

Joshua Bettinger
Mark Bodin
Barbara A Bryce
Cindy and Joe Callahan
Annie M Card
Katie and Robert Sutherland
Kathy and Mike Chelstowski
Philip and Chris Clay
Allen Cohen
Pat and John Colony
Stephen and Janice D'Alessio
Thomas W. and Jean Dobson
Ren and Melanie Doyle
Werner and Deborah Drouin
Timothy J Dziejcz and Janet Gordon
Tamara Evanson
Ron Farina
Leanne Farr
Donovan Fenton
Lisa E Fisk
Cortney French
Dawn Gallagher
Linda and Joe Garner
Michael Genest and Kathie Brennen
Peter and Diane Guay
Sandy and Rob Hamm
Frances Heap
Martha and Helmut Heidl
Arunas S Jonynas
Carol Jue
Gregg Kleiner



INDIAN KING FRAMERY

Exceptional Designs & Friendly Service since 1976

Complete Picture
Framing Services
For Home & Business

The Region's Largest
Component Framing
Department

Pickup, Delivery
& Installation Services



Conservation
Specialists

Fine Art Reproduction

Convenient Free Parking

Hours:
Monday by appt. or chance
Tuesday-Friday 10-5
Saturday 10-3

The Center at Keene | 149 Emerald Street, Suite D2 | Keene, New Hampshire 03431
(603) 352-8434 | www.IndianKingFramery.com

INDIVIDUAL MEMBERS CONTINUED

Richard Lammers
Elizabeth Littlefield
Nancy and Gordon Luce
Jackie Lyon
Ray and Ann Mahoney
Randyn Markelon
Ludger and Theresa Morin
BA Munroe and T Eisner
Margie Palmer
Lawrence and JoAnn Robinson
Bernie and Jane Rokes
Greg Rothman and Linda Singer
Pamela Jean Savory
Paul and Melody Scheuring
Dr. John and Charlotte Schuerman
Michael and Pattie Schuman
Geri Shaw
Janet and Woody Shook
Bob and Mary Sisson
Carlton and Melissa Stewart
Bob and Katie Sutherland
James Sutton
Robert Swartz
Richard J. Talbot
Jonas Taub
George Thompson
Eleanor Vander Haegen
Suzanne and Peter Whittemore
Mark Williams
Warren Witherell
Natalie Zinski

FRIEND

Gregory Anderson
Joanne Angell
Pat Arancio
Burchell Bales
Loretta Lynn Bamforth
Christopher and Claire Bean
Anna Behrens
Dean Bennett
Dr. Paul Robert Benson
Jacqueline Bilodeau
Judy Blake
Teri Boucher
RebeccaBoutell

Stephen and Deborah Brown
William and Beth Buoro
Scott Butler
Kathryn and James Butterfield
Kristin Canney
Kendra Carter
Julia Clebsch
William Davis
Deborah Decicco
Catherine Degreenia
Michelle Dellavita
John and Jean Diamond
Sharon Dion
Carl Douai
Michael and Peggy Dunham
Daniel Fabien
Richard Feldman
Peggy Fischer
Richard Frank
Beth and Bill Franzen
Frank Gallo
Kathleen F. Gavin
Bruce Charles Gilman
Tim Clover
Cecile Goff
Jennifer Gross
Rachel Hancock
Jeanne Hearn
Lorena Rose Hoffman
Lisa Holmes
Philip Cate Huckins
Sue Ann and Rick Hum
Lynne Irwin
Erwin Kann
Marcia Kayser
Mary C Kelly
Carolyn Kersbergen
Sonia Kibbee
Jane Kirkpatrick
Alice M Lindquist
Steven Lord
Doreen Lucius
Michael Marsden
Sam and Michael Clark
Lizabeth McLaughlin

Guyer & Son
ROOFING
Your Local Roofer For Over 50 Years

GIVING
TUESDAY

2023/2024
Monadnock United Way
Match Lead Sponsor

**COMMITTED TO
GIVING BACK TO
OUR COMMUNITY**

**YOUR LOCAL
ROOFER FOR
OVER
50 YEARS!**

**RESIDENTIAL
& COMMERCIAL**

- Full Roof Replacements
- Metal Roofs
- Asphalt Shingle Roofs
- Flat Roof Installations
- Specialty Roofing
- Roof Repairs
- Flashing
- Storm Damage Repair
- Slate Repairs
- And More!

**Call for a
FREE
Estimate today!**

603-876-9915

49 Granite St. Marlborough
NH 03455

Guyeroofing.com



Tom Montagno
Rosemary Morse
Tim and Pam Murphy
Richard William Newton
Christina L O'Brien
Dean Ogelby
Kerry O'Neill
Marina Canaris Perrin
Paul and Dawn Piccolomini
Deborah Pickering
Stacie Pirozzi
Thomas Reynolds
Daryl and Patricia Royce
Donald J Schrock

Eric And Laura Semple
Dr. Rachel Simon
Michael and Wendy Sisto
Gary Skantze and Judith Grant
Rick Spring and Kristen Earle
Mr. & Mrs. Stephen V Stiles
Catherine J Stone
John T. and Suzanne Stoodley
Jeanie M. and Walter P. Sy
Russ Cobb and Brett Amy Thelen
Jeff and Karen Titus
Robin and Tim Toussaint
Steve and Sue Vekasy
Mr. & Mrs. Gary H Weiss

Mark and Vickie Woodford
David Young

As of AUGUST 1, 2024

**THANK YOU
TO ALL
OF OUR
MEMBERS!**



**HELP US IMPROVE YOUR COLONIAL EXPERIENCE!
FILL OUT THIS SHORT SURVEY AND BE ENTERED
INTO A MONTHLY DRAWING.**

WE APPRECIATE YOUR TIME.

Welcome to the theatre! As you all know, this is a shared human experience. It is made and managed by dedicated, caring people. All the professionals working in this theatre are here to help you. They are trained and knowledgeable, and want you to have the best experience at the show.

As audience members, you are essential to this performing arts experience—the show could not go on without you. You play an important part of the show by helping maintain the sanctity of this space.

TO HELP YOU (AND THE PEOPLE AROUND YOU) HAVE THE BEST TIME, WE PLEASE ASK THAT YOU:

- § Always cooperate with the ushers and front-of-house staff. They are here to help you, keep an orderly environment, and ensure the show begins on schedule.
- § Treat all theatre staff you see with respect and kindness. They want you to have a great time, and they deserve respect and a positive work environment.
- § Be engaged with the show! But also respectful of the people around you and do not make any overly disruptive comments.
- § Turn off your cell phone. All the way off...
- § Stop drinking alcohol immediately if you're feeling tipsy. Drink some water.
- § Be patient with the restroom lines. We know they're long and space is tight. But do not become pushy or rude. Everyone will get their turn.
- § Relax, sit back and enjoy the show! Once again, we could not be here without you.



DOUGLAS®

Thank you
Colonial Theatre
for inspiring our
community.



DouglasToys.com

Silver Direct Inc.

marketing • design • print • web



Now Offering
Vehicle Lettering
& Graphics

Creators of effective marketing materials
for small and large businesses

GRAPHIC DESIGN

Logos • Business Cards • Postcards • Catalogs • Direct Mail Packages •
Ads • Flyers • Programs • and more...

PRINTING SERVICES

Oversized Posters • Event Materials • Roadside Signs • Banners • Signs
• Business Cards • Postcards • Brochures • Newsletters • Wedding
Invitations • Calendars • Direct Mail • PR Kits • and more...

WEB BASED SERVICES

Website Design • Website Redesign • Email Blasts • Online Ad
Campaigns • Online Banner Ads • Social Media

351 Monadnock Highway, Swanzey, NH 03446

603-355-8855 • www.silverdirectinc.com

 Find us on
Facebook



Let's get a round of applause

From pen to page, brush to gallery, rehearsal to stage, and everywhere in between — we're proud to sponsor our local artists and artisans. Creativity builds connections, and at NBT Bank, we believe that inspiration is best when celebrated and shared. Thank you for using your talent and passion to make our communities shine.



Dublin Health & Benefit Group LLC.

- ✓ Medicare Insurance
- ✓ Individual Insurance/
Healthcare.gov Insurance
- ✓ Dental Insurance
- ✓ Vision Insurance

603.563.8820

1248 Main Street Dublin, NH 03444

www.dublinhealth.net



A BRIEF HISTORY OF THE COLONIAL THEATRE



The Colonial Theatre on Opening Night in 1924



The Colonial Theatre Marquee on the night of the 70th Anniversary Celebration, 1994

- 1923 Construction of the Colonial Theatre begins.
- 1924 January 29, the Colonial Theatre opens with the silent film *The Hunchback of Notre Dame*. Owner Charles Baldwin gives away 6,000 free tickets.
- 1929 Thornton Wilder begins spoken-word tradition reading *The Women of Argos*.
- 1932 Amelia Earhart lectures on the possibility of trans-Atlantic air travel; Maude Adams, the highest-paid actor of her day, performs her final role as Maria in Shakespeare's *Twelfth Night*.
- 1944 Iconic neon marquee installed; in continuous use through present day.
- 1945 Live entertainment discontinued.
- 1950s Permanent Cinemascope screen installed.
- 1984–1993 The Colonial Theatre purchased and operated by Steve Levin & Ira Gavin. Live entertainment returns with performances by artists such as John Prine, Bonnie Raitt and Emmylou Harris.
- 1993 The Colonial Theatre Group, Inc. is formed as a nonprofit corporation and purchases the Colonial Theatre.
- 1994–2000 The Colonial undergoes restoration.
- 2007 Aging main doors and clerestory windows replaced with renewably sourced, locally crafted, historically accurate doors and windows.
- 2019 The Colonial Theatre celebrates 95 years of continuous operation and 25 years as a nonprofit organization. The process begins to undergo a major renovation and rebrand as the Colonial Performing Arts Center.
- 2020 COVID-19 closes the doors of The Colonial Theatre in March. The building at 20 Commercial Street is purchased and renovations begin to create a second smaller venue (SHOWROOM).
- 2021 The Colonial Performing Arts Center announces a 10.5 million dollar capital campaign. SHOWROOM is completed and begins operations. Renovations begin on the historic theatre.
- 2022 The newly renovated historic theatre opens to the public in April.
- 2023–2024 **THE COLONIAL CELEBRATES 100 YEARS!**

100
years!
1924-2024

COLONIAL

PERFORMING ARTS CENTER

COLONIAL COLONIAL

CELEBRATING 100 YEARS!

THANK YOU FOR YOUR SUPPORT

WEEKLY PROGRAM

THE COLONIAL

KEENE, NEW HAMPSHIRE



February 11 to 16, 1924

It is in the Best - You Will See It Here

COLONIAL THEATRE

The Greatest Screen Attraction of the Age

CARL LAEMMLE Presents

VICTOR HUGO'S

The HUNCHBACK of NOTRE DAME

with ERNEST TORRENCE - PATSY RUTH MILLER - NORMAN KERRY - TULLY MARSHALL and the Greatest Cast Ever Assembled

5 MONTHS AT THE NEW YORK THEATRE

3 MONTHS AT THE BOSTON THEATRE

with ERNEST TORRENCE - PATSY RUTH MILLER - NORMAN KERRY - TULLY MARSHALL and the Greatest Cast Ever Assembled

SYMPHONIC ORCHESTRA and MUSICAL EFFECTS Under Direction of F. S. TRUDA, Boston

Three Days - 3 Consecutive MONDAY, FEBRUARY 4

Twice Daily 2:30 - 4:00
Five Shows
15c, 25c, 35c, 45c, 55c, 75c, \$1.10
Tax Included

Seats on Sale Tuesday, January 29 1:00 o'clock - At Box Office

ALL SEATS RESERVED

Order Now Phone 1130



Amelia Earhart,
World's Premier Aviator

Appearing Personally

at the

Colonial Theatre

Keene, N. H.

In her lecture, "Flying for Fun" Accompanied by Moving Pictures

Monday, Nov. 14, 1932

8 p. m.

Benefit Crippled Children's Fund of the Keene Rotary Club

Admission \$1, All Seats Reserved

Exchange Tickets at Ballard & Shedd's

ANNOUNCING THE OPENING OF

COLONIAL THEATRE

TUESDAY AND WEDNESDAY

JANUARY TWENTY-NINTH AND THIRTIETH

A MOST CORDIAL INVITATION TO VISIT THIS THEATRE DURING THE OPEN HOURS OF THESE TWO DAYS

IS EXTENDED TO THE CITIZENS OF KEENE AND SURROUNDING COUNTRY

MATINEES

NO ADMISSION CHARGE

THESE ATTENDING THE AFTER NOON PERFORMANCES MUST COME TO THE THEATRE TO INSPECT THE THEATRE

ATTENTION

IS CALLED TO THE THEATRE DURING THESE PERFORMANCES. THESE PERFORMANCES WILL BE HELD IN THE THEATRE AND WILL BE OPEN TO THE PUBLIC. THESE PERFORMANCES WILL BE HELD IN THE THEATRE AND WILL BE OPEN TO THE PUBLIC. THESE PERFORMANCES WILL BE HELD IN THE THEATRE AND WILL BE OPEN TO THE PUBLIC.

EVENINGS

NO TICKETS REQUIRED

WE MUST REQUEST THAT ALL CHILDREN UNDER AGE BE ACCOMPANIED BY PARENTS AT ALL PERFORMANCES

CHARLES C. BALDWIN, Manager

We Will Endeavor to Give You An Entertainment In Keeping With The House

R



Photo by MICHAEL MOORE / Ontario Star

Hundreds turn out for 'Jumanji' screening at Colonial

1999 THEATRE PHOTOGRAPH and REPORT

Name: _____ Date: _____

Address: _____ City: _____

Phone: _____

Other Photo Taken: _____

Send Address: _____

City: _____ Phone: _____

State: _____

By: _____

For: _____



FOUNDATION & OTHER SUPPORT

BANK OF AMERICA FOUNDATION

CHURCH & MAIN FUND FOR THE CREATIVE ARTS

CMH FOUNDATION

EPPEJ-JEFFERSON FOUNDATION, INC.

EVERSOURCE ENERGY FOUNDATION, INC.

GALLUP FOUNDATION

KEENE PRIDE

THE KINGSBURY FUND

MASCOMA SAVINGS BANK FOUNDATION

NEW ENGLAND FOUNDATION FOR THE ARTS

NEW HAMPSHIRE CHARITABLE FOUNDATION

NEW HAMPSHIRE STATE COUNCIL ON THE ARTS

PUTNAM FOUNDATION

ROBIN COLSON MEMORIAL FOUNDATION

AS OF AUGUST 1, 2024

YOU'RE INVITED UPCOMING LECTURES

SAVE THE DATES for these special events presented by the Cohen Center for Holocaust & Genocide Studies:



SEP. 24, 2024

HOLOCAUST MEMORIAL LECTURE

*Feat. Professor
Caroline Sturdy
Colls*



APRIL 2, 2025

GENOCIDE AWARENESS LECTURE

Presented via livestream

*Feat. Professor
Victoria Sanford*

All events will be open to the public. Tickets must be reserved in advance.

Please visit [keene.edu/cchgs](https://www.keene.edu/cchgs) for more information about all upcoming events, workshops, and other offerings.



Cohen Center for Holocaust
and Genocide Studies
KEENE STATE COLLEGE



A Ministry of Trinity Lutheran Church

**Academically Excellent,
Christ-Centered Education**

Preschool - 8

Financial Assistance Available

**TCSKeene.com
603-352-9403**

**100 Maple Ave
Keene NH 03431**

HKS Associates knows Monadnock real estate

We have been serving the region for over 60 years. Whether you are buying or selling, call today to schedule a confidential and complementary meeting with a seasoned consultant.



603-352-6030

keene@hksassoc.com

www.hksassoc.com



**R&R Oil Tanks LLC
603-762-4111**

Locally owned and operated

Over 20 years of experience

Quality work at a fair price

Fully insured • Roth certified

**We specialize in
residential and commercial
home heating oil tanks**



RandROilTanks.com

Reasons to Support the Arts

ARTS FOR THE HEALTH AND WELL-BEING OF OUR MILITARY

Military service members and Veterans rank creative arts therapies in the **top four (out of 40)** interventions and treatments.



Across the military continuum, the arts **promote resilience** during pre-deployment, deployment, and reintegration of military service members, Veterans, their families, and caregivers into communities.

@artsactionfund
@americans4arts

Provided by AmericansForTheArts.org.

The Metropolitan Opera

2024–2025 SEASON **HD LIVE**

JEANINE TESORI, LIBRETTO BY GEORGE BRANT
GROUNDED

1:00 PM / Saturday, October 19

JACQUES OFFENBACH *LES CONTES D'HOFFMANN*

1:00 PM / Saturday, October 26

GIACOMO PUCCINI *TOSCA*

1:00 PM / Saturday, November 23

WOLFGANG AMADEUS MOZART *MAGIC FLUTE*

1:00 PM / Sunday, December 15

GIUSEPPE VERDI *AIDA*

12:30 PM / Saturday, January 25

LUDWIG VAN BEETHOVEN *FIDELIO*

1:00 PM / Saturday, March 15

WOLFGANG AMADEUS MOZART *LE NOZZE DI FIGARO*

1:00 PM / Saturday, April 26

RICHARD STRAUSS *SALOME*

1:00 PM / Saturday, May 17

GIOACHINO ROSSINI

IL BARBIERE DI SIVIGLIA

1:00 PM / Saturday, May 31



INVEST IN THE COLONIAL

As a Member of The Colonial, you do so many things:

- You bridge the financial gap to help us bring compelling and unique shows to our venue.
- You contribute to the economic growth, community vitality and culture of the Monadnock Region.
- You are an active participant in the future of the Theatre.

Our members feel good knowing that they support a nonprofit in our community that is committed to quality programming for diverse audiences.

We cannot do what we do without our members!

What do you like about being a member of The Colonial?

Let us know at: sam.clark@thecolonial.org



COLONIAL
PERFORMING ARTS CENTER

UNIQUE EVENT SPACE

*...directly behind
The Colonial!*

*a place to check out
up-and-coming artists, to see
your favorite regional
performers or to catch
a great film.*

AVAILABLE FOR SPECIAL EVENTS AND CORPORATE FUNCTIONS

Flexible Configuration

140 Seated, 300 Standing

Dressing Rooms

Catering Kitchen

In-House Sound & Lighting

20' Wide Projection Screen

HD Video & Cinema Sound

Convenient Downtown Keene Location

MORE INFORMATION:

603-357-1233 or admin@thecolonial.org



SHOWROOM

COLONIAL PERFORMING ARTS CENTER

20 Commercial Street, Keene, NH 03431 · thecolonial.org/showroom



MODESTMAN

Beer Different.

Modestman Brewing

Now serving up fresh Neapolitan-style pizza using the finest ingredients!

See our website for Taproom & Kitchen Hours

100 Main Street, Keene, NH 03431

(603) 352-7695

www.modestmanbrewing.com

@modestmanbrewing

NOW OPEN:

Our satellite tasting room in South Portland, Maine!

Because a strong
Cheshire Medical Center
means a healthier
community.



Cheshire Health
Foundation

Supporting the health and wellness mission of Cheshire Medical Center, a non-profit organization caring for our community for 131 years and counting.

www.Cheshiremed.org/CHF

The show must go on.

(And so must the power!)

Proud to support this electrifying season at the Colonial—and proud to supply standby power to our region, with turnkey generator installation, battery storage, and custom service options for guaranteed peace of mind.



800-853-7202 • powersguaranteed.com



Professional and Compassionate

Dentistry for Monadnock Area Families



Preventative & General Dentistry



Invisalign



Pediatric Dentistry



Cosmetic Dentistry



Emergency Care



New Patients
Always Welcome!

R Raynor Dental

RaynorDental.com

650 Court St, Suite 4
(603) 352-0006



EXPERIENCE THE DIFFERENCE

at Monadnock Ford!



CALL OR VISIT ONLINE TODAY FOR YOUR NEW FORD
603-283-5900 • MonadnockFord.com

ARTS RESOURCES



Mini grants, events, research, coaching & more for artists.

ARTS INCUBATION



Fiscal sponsorship for start-up arts nonprofits.

DISCOVER MONADNOCK



Promotion of regional arts & culture online & in print.



LEARN MORE, DONATE, GET INVOLVED
AT MONADNOCKARTSALIVE.ORG

SERVICE YOU DESERVE
PEOPLE YOU TRUST



RE/MAX
TOWN & COUNTRY

117 WEST STREET
KEENE, NH 03431
(603) 357-4100
www.mykeenehome.com

MONIFF
MONADNOCK INTERNATIONAL
FILM FESTIVAL

MONIFF.ORG



Granita
ENOTECA

Experience Modern Italian
Cuisine, Select Wines and
Handcrafted Cocktails
before your next Show
at the Colonial.



(603) 355-5242
51 Railroad St Keene, NH
www.granitakeene.com



BRINGING FILMS &
COMMUNITY TOGETHER



Bra Fitting
Lingerie
28-48, A-O



FranklinPierce
UNIVERSITY

ONE UNIVERSITY, BOUNDLESS OPPORTUNITY.
Study in-person, hybrid or online – programs made to fit your life.



franklinpierce.edu
Follow us @franklinpierceuniversity

Beautiful Furniture

TO COMPLEMENT YOUR HOME, YOUR LIFE, AND YOUR BUDGET.



Frazier & Son
FURNITURE



233 Old Homestead Highway
(Route 32, south of the airport)
Swanzey, New Hampshire
Monday - Friday 10 to 6
Saturday 10 to 5 - Sunday Closed

* FAMILY OWNED AND OPERATED FOR MORE THAN 60 YEARS *

(800) 494-3876 • (603) 352-0337

www.frazierandsonfurniture.com

LABOY
Flexsteel England



COLONIAL

**CORPORATE MEMBERS:
YOUR NAME HERE!**

**CORPORATE MEMBERSHIP HELPS PROMOTE
YOUR COMPANY AS A SOLID COMMUNITY LEADER –
NO MATTER WHICH LEVEL YOU CHOOSE!**

CORPORATE MEMBERSHIP STARTS AT \$250. BENEFITS VARY BY LEVEL AND INCLUDE:

- Lobby, program, annual report and newsletter acknowledgment
- Advertising discounts in the Season Program
- Group rate discounts to live events
- Advance ticket notice
- Complimentary individual memberships, tickets and film passes
- Your logo displayed in the season brochure and distributed throughout the season (pledges made before May 15), and at TheColonial.org with a link to your website
- Your business name and logo placed in all of your featured event's publicity
- Your company name on The Colonial marquee
- Recognition of your support from the stage prior to your featured event
- Additional preferred seating for your featured event at a 10% discount

**BECOME A CORPORATE MEMBER OF
THE COLONIAL.**

For a complete listing of corporate membership levels and benefits,
contact Sam Mathewes Clark
sam.clark@thecolonial.org

CORPORATE MEMBERS 2024-25 SEASON

SEASON UNDERWRITER C&S FAMILY OF COMPANIES VISORY

EXECUTIVE PRODUCER

FENTON FAMILY DEALERSHIPS
FRAZIER & SON FURNITURE

PRODUCER

GREAT EASTERN RADIO/THE PEAK

DIRECTOR

DOUGLAS COMPANY
HAMBLET ELECTRIC, LLC
THE KEENE SENTINEL
THE KINGSBURY FUND

INVESTOR

CLARK-MORTENSON INSURANCE - A HILB GROUP COMPANY
D'ALESSIO & ASSOCIATES, INC.
G & H KEENE/STINGRAY
MELANSON COMPANY
MONADNOCK MEDIA GROUP
NEW HAMPSHIRE PBS
NORTHEAST DELTA DENTAL
PARAGON DIGITAL MARKETING

PARTNER

HARRISVILLE DESIGNS
INDIAN KING FRAMERY
KCS ARCHITECTS
STEELMAN PRODUCTION SERVICES

BENEFACTOR

DEEP ROOTS MASSAGE
KEENE YOUNG PROFESSIONALS NETWORK
THE MONADNOCK SHOPPER NEWS

BACKER

CC&D'S KITCHEN MARKET
COURTYARD BY MARRIOTT
FILTRINE MANUFACTURING COMPANY
FIREWORKS RESTAURANT
OSTER & WHEELER, P.C.
PEOPLE'S LINEN
SAVINGS BANK OF WALPOLE
SILVER DIRECT

SUSTAINER

BRANDIE WELLS, THE BREAKTHROUGH MEDIUM
KEENE PRIDE
MADAME SHERRI'S LOUNGE AND CABARET
MUSE BISTRO
SOLE'S

PATRON

EAT MORE CAKE
KEENE ON COOKIES LLC
NEW HAMPSHIRE PUBLIC RADIO

AS OF AUGUST 1, 2024

AMT

PRODUCTIONS

- Event & Theatrical Lighting
- Live Sound
- Video Production
- Live Streaming
- Sound and Lighting System Installs

603-209-4295

alex@amt-productions.com

www.amt-productions.com

802-721-6916 | kurnhattin.org



Positively
transforming
children's lives.

Kurn Hattin Homes
for Children

The best care in
the best place.



Dartmouth
Health

Cheshire Medical Center

cheshiremed.org

Green Cleaning Products
Janitorial Supplies & Paper Products
Restaurant Supplies



Sales • Service
Repair

Where the vacuums suck, but the prices don't!

John & Teri Boudreau
Proprietors

451 West Street
Keene, NH 03431
(603) 352-5085

Mon. - Fri. 9-5
Sat. 10-4



www.thevacuumstoreofkeene.com



DUBLIN
SCHOOL
1935

VENTURE WITHIN

A High School Community
of Kind, Ambitious and
Curious Students.

Fenton Family
DEALERSHIPS

TOYOTA VOLVO HONDA HYUNDAI SUBARU

The BEST Brands
with over 300 used cars in stock

State of the Art Service Facilities



Toyota of Keene, Volvo Cars Keene, Honda of Keene
591 & 567 Monadnock Hwy, Swanzey, NH 03446

Hyundai of Keene, Subaru of Keene
14 & 11 Production Ave, Keene, NH 03431



www.fentondealerships.com (603) 354-5100



good. local. food.



SUPPORTING LOCAL SINCE 2013

\$39M *in* **LOCAL SALES**
SUPPORTING LOCAL FARMS
and FARM FAMILIES

\$193K INVESTED
in 20 LOCAL FARMS *through*
THE MONADNOCK FOOD CO-OP
FARM FUND

34 CYPRESS ST | KEENE NH
MONADNOCKFOOD.COOP

Proud Sponsor of the
Colonial Performing Arts Center
and supporter of the Arts
in our Community

NHTrust
FINANCIAL ADVISORS

603.354.4059
nhtrust.com

Not FDIC Insured	Not Bank Guaranteed
May Lose Value	Not a Bank Deposit
Not Insured by Any Federal Government Agency	
Meeting with NHTrust is without obligation or cost.	



The New Hampshire Dance Institute
wishes to congratulate The Colonial for
bringing music, dance and theatre to our
community for 100 years!

C.M.MINKLER
PAVING & PAINTING LLC

"THINK MINK"



Veteran Owned ■ Fully Insured ■ Serving VT, NH, MA



PAVING

- RESIDENTIAL
- COMMERCIAL
- DRIVEWAYS
- HARD PACK
- EXCAVATING & DIRT WORK
- PARKING LOTS
- PATCH WORK
- OIL & STONE



PAINTING

- COMMERCIAL
- RESIDENTIAL
- INTERIOR
- EXTERIOR
- POWER WASHING
- PICKLING



SEALING

- PATCH REPAIR
- CRACK FILLING
- SEAL COATING
- LINE PAINTING
- STENCILING

THINKMINKPAVINGANDPAINTING.COM

603-414-7997



THE CHESTERFIELD PUBLIC SCHOOL FOUNDATION

Supporting, promoting and encouraging the advancement and innovation of education for the students of the Chesterfield School.



CPSF is proud to partner with The Colonial Performing Arts Center by funding a trip for all Chesterfield students to a yearly live performance.

ChesterfieldPSF.com

THE COLONIAL THEATRE VOLUNTEER USHERS

BECOME AN USHER!



Colonial volunteer ushers come from all walks of life: professionals, retirees and students. Participants enjoy many benefits as ushers: service to the community and the arts, camaraderie with other volunteers and the opportunity to see the variety of world-class performers who entertain our community.

thecolonial.org/about/volunteers/

In the 2023-2024 Season, ushers contributed 3,836.15 hours which is valued at \$132,884.58 (per Independent Sector).

THANK YOU TO OUR USHERS:

Lisa Antonuccio
Jonathan Baer
Madonna Baker
Janis Barnes
Julie Barrett
Jeanette Bergeron

Christopher Black
Kathleen Blackwood
Lynne Bonnette
Lorraine Bramble
Colleen Brophy
Pat Burger

Grant Butler
Jennifer Butler
Tom Buttrick
Suzanne Charle
Patricia Clarks
Virginia Clark



**FAMILY OWNED
AND OPERATED**
FOR OVER 30 YEARS

**EXIT 3 OFF 91 NORTH
BRATTLEBORO, VERMONT**

*Visit our State of the Art
Chevy / GMC Sales & Service Center*



WE DELIVER

**WE SERVICE ALL
MAKES AND MODELS**



Sara Clough
Karen Cloutier
Ian Colson
Marcia Contarino
Kevin Croteau
Shay Croteau
Hilda de Moya
Donna Dearth
Dale DiMauro
Sharon Dion
Pam Durkin
Jean Dwight
Pete Dwight
Timothy Dziedzic
Charles Ferrando
Frank Fratea
Janet Gordon
Riki Greenwald
Anne Guerriero
Elizabeth Gunnell
Charlene Haas
Jean Harshbarger
Devoe

Chuck Hannah
Heidi Hannigan
Elizabeth Hansel
Tom Haynes
Peggy Higgins
Gretchen Hoefler
Sharon Iagulli
Andi Johnson
Vicki Keller
Gordon Kent
Mark Koolen
Don Ladd
Karoline Ladd
Connie LaFleur
Liz Lajoie
India Lawrence
Jeannine Leclerc/
Romeo
Kayle Luther
Terry Manahan
Monica Marshall
Susan Matthews
John Matthews

Tina Mattison
Cheryl McDaniel-
Thomas
Jan McGonagle
Deb McWethy
Susan Megas-Russell
Craig Miller
Lisa Morales
Chris Nelson
Carol Newcombe
Tom Newcombe
Bonnie Nikiforakis
Bruce Norlund
Emma Ortiz
Cheryl Patty
Lisa Perkins
Valerie Piedmont
Deborah Piragis
Karen Richardson
Susan Rigg
Eli Rivera
Jennifer Rivera
Dee Robbins

Lorie Rogers
Robin Romeo
Michael Romeo
Stephen Russell
Stella Scott
Ed Selby
Indira Singh
Jennifer Sizoo
Peg Smeltz
Denise Smith
Craig Sylvern
Robin Sylvern
Vicki Tacy
Chris Thompson
John Waibel
Elaina Waibel
Elizabeth Wasilewski
Les Wasilewski
Kevin Wilcox
Ellen Wishart
Michael Zonczyk



PROUD TO SUPPORT THE ARTS...
AND YOUR BACK!

Syd's
Carpet & Snooze Room

FURNITURE • FLOORING • BEDDING

SYDSOFKEENE.COM
43 SAINT JAMES STREET
KEENE, NH

603-352-4315



Reasons to Support the Arts

**ARTS DRIVE
TOURISM AND
REVENUE TO
LOCAL BUSINESSES**

Arts attendees spend on average **\$31.47 per person**, per event, beyond the cost of admission on items such as meals, parking, and lodging which is vital income for local businesses.

Arts travelers stay longer and spend more money seeking out authentic cultural experiences.

@artsactionfund
@americans4arts

Provided by AmericansForTheArts.org.

**CHANGE LIVES.
START WITH
YOUR OWN.**

GAIN THE SKILLS
YOU NEED TO
DO MORE GOOD,
AND ADVANCE
YOUR CAREER.



**ANTIOCH
UNIVERSITY**

FIELDSTONE
LAND CONSULTANTS, PLLC

(603) 672-5456

- ◆ SURVEYING
- ◆ ENGINEERING
- ◆ ENVIRONMENTAL
- ◆ SEPTIC DESIGNS
- ◆ PERMITTING
- ◆ LAND PLANNING

SERVING NH, VT, MA & ME

KEENE OFFICE MILFORD OFFICE
45 ROXBURY STREET 206 ELM STREET
KEENE, NH 03431 MILFORD, NH 03055

FIELDSTONELANDCONSULTANTS.COM



Invite the Extraordinary!
CONCERTS & EVENTS
ALL YEAR LONG!



VISIT
monadnockmusic.org
for full schedule of free
and ticket concerts

MONADNOCK
MUSIC
.....

EDUCATION AND OUTREACH FOR SCHOOLS PRE-K - 12

2024-2025

STUDENT PROGRAMMING

ALL MATINEES START AT 10AM

FINDING NORTH

FEBRUARY 13, 2025 GRADES 5-8 (AGES 10+)

MATH MANIAC

MARCH 19, 2025 GRADES 3-5

KATTAM AND HIS TAM TAMS

APRIL 2, 2025 GRADES 2-8

ADA TWIST, SCIENTIST AND FRIENDS

MAY 14, 2025 GRADES K-4

FAMILY ENTERTAINMENT

JOHN HUGHES

KEENE INTERNATIONAL FESTIVAL

SEPTEMBER 28, 2024 FREE EVENT!

THE BIG NAZO

KEENE PUMPKIN FESTIVAL

OCTOBER 12, 2024 FREE EVENT!

MUTTS GONE NUTS

NOVEMBER 17, 2024

NYTB'S THE NUTCRACKER

DECEMBER 7, 2024

A CHARLIE BROWN CHRISTMAS

DECEMBER 28, 2024

DRAGONS AND MYTHICAL BEASTS

APRIL 5, 2025



EDUCATION & COMMUNITY EVENTS

The Colonial is passionately invested in the cultural health of our community through our commitment to providing community engagement for all ages, making the performing arts a vital and fundamental part of education. Our educational programs are designed to engage in the artistic process, cultivate appreciation for the performing arts and celebrate our diversity as a community.

OPERA-TUNITY PROGRAM

An intro to opera or a live performance

ATTEND THE MET: LIVE IN HD

Tickets are free to select operas for children in grades 4-12

Email vicky.pittman@thecolonial.org

Provided by the Putnam Foundation and the Metropolitan Opera House

SEASON UNDERWRITER



MET LIVE IN HD SUPPORT PROVIDED BY

**PUTNAM
FOUNDATION**

ADDITIONAL SUPPORT PROVIDED BY



KYPN
REAL ESTATE PROFESSIONALS NETWORK



EDUCATION AND COMMUNITY ENGAGEMENT PROGRAM

WHY EDUCATION AND COMMUNITY ENGAGEMENT FOR THE COLONIAL?

WHY EDUCATION AND COMMUNITY ENGAGEMENT FOR THE COLONIAL?

Culture. The single word can define us. Give us a sense of belonging.

The dictionary definition of culture reads, “a particular form or stage of civilization, as that of a certain nation or period.” However, culture is much more than definition. This one word carries the power to engage, educate and enrich the quality of life. This one word gives meaning to our past, present and future.

The many unique aspects of culture can be shown through artistic expression. Art is a universal language that can bridge divides within a community, act as a vessel to share stories, raise awareness and celebrate all cultures.

The Colonial is passionately invested in the cultural health of our community. We are committed to providing community engagement for all ages, and to elevating the performing arts as a vital and fundamental part of education. Our educational programs are designed to share the artistic process, cultivate appreciation for the performing arts and celebrate our diversity as a community.

COLLABORATORS IN COMMUNITY ENGAGEMENT

- Apple Hill Center for Chamber Music
- Arts Alive
- Art Walk
- Badger Balms
- Bees Tees
- CC&D
- City of Keene
- Cohen Center for Holocaust and Genocide Studies
- Deep Roots
- Eat More Cake
- Elegant Settings
- Historical Society of Cheshire County
- Keene International Festival
- Keene Pride
- Keene Sentinel
- Keene State College – Office of Justice, Diversity, Equity and Inclusion
- Keene Young Professionals Network
- MoCo Arts
- Monadnock Music Festival
- MONIFF
- NNDI
- Nova Arts
- Peterborough Players
- The Production House
- Silver Direct
- YMCA

2023-24 SEASON

COLONIAL EDUCATION AND ENGAGEMENT ACTIVITIES

CLOSE TO 9000 MEMBERS OF THE PUBLIC ENJOYED 2023-2024 COLONIAL COMMUNITY ENGAGEMENT PROGRAMS THAT WERE FREE OF CHARGE.

The Colonial Partners with Annual Community Events

- Art Walk
- Taste of Keene
- Keene Pumpkin Festival
- Keene Ice and Snow festival
- Juneteenth

Colonial Education & Engagement for Students

- **American Ballet Theatre** open rehearsal/warm up
- **Cirque Fabrique** warm up and post-show Q&A
- **Kurn Hattin** - Film students theatre tour & short film
- *The Life and Times of Malcolm X* -Met Live in HD
- *The Magic Flute* -Met Live in HD Opera - taught in school class time –opera, orchestra, theater
- *Romeo & Juliet* -Met Live in HD Opera -taught in school class time – opera, orchestra, theater
- *Madama Butterfly* -Met Live in HD
- *Carmen* -Met Live in HD



Colonial Education & Community Engagement Sponsorship 23-24

- Bank of America
- Main Street America
- Fenton Family Dealerships
- Metropolitan Opera House
- New England Foundation of the Arts
- NH Charitable Foundation
- Putnam Foundation
- Walpole Savings Bank
- Send a Kid Sponsors and Fundraiser Donations

Colonial Education & Engagement Through Film

- *Everybody's Talking about Jamie* - Celebrating Pride Month
- *Incident at Restigouche* (1984); *Our People Will Be Healed*; *Gene Boy Came Home* (Aboriginal Veteran) - 3 short films by Alanis Obomsawin, winner of the 65th MacDowell Gold Medal in 2023 (Indigenous History)
- *Kid Flicks: Celebrating Black Stories*, for JUNETEENTH
- *Loving Vincent* - ArtWalk
- *The Hunchback of Notre Dame* (silent film from 1924)

ARTS ADVOCACY

Community & Arts Impact Points made by The Americans for the Arts

- **LOW-INCOME STUDENTS** who participate and attend the performing arts, both in school and after school, have a dropout rate of just 4 percent—five times lower than their peers.
- **FIELD TRIPS TO LIVE THEATER ENHANCE LITERARY KNOWLEDGE,** tolerance and empathy among students, according to a study published by researchers in the University of Arkansas Department of Education Reform.
- **PEOPLE WHO ATTEND AND ARE INVOLVED IN LIVE** theater meet more people... making marginalized groups more visible and promote positive community connections.
- **THE ARTS ENCOURAGE** community partnerships, intercultural understanding, and stronger connections within the community

Reasons to Support the Arts

ARTS IMPROVE ACADEMIC PERFORMANCE

91% of Americans believe that arts are part of a well-rounded K-12 education

Students engaged in arts learning have **higher GPAs, standardized test scores, and college-going rates** as well as **lower drop-out rates** - benefits found across all socio-economic classes.

However, the Department of Education reports access to arts education for students of color is **significantly lower** than for their white peers.



@artsactionfund
@americans4arts

Provided by AmericansForTheArts.org.

Reasons to Support the Arts

ARTS STRENGTHEN MENTAL HEALTH

Studies show that the arts are effective in building resiliency, **reducing depression and anxiety**, and **increasing life satisfaction**.

Just **30 minutes** of arts activities daily can combat the effects of isolation and loneliness associated with the COVID-19 pandemic.



@artsactionfund
@americans4arts

Provided by AmericansForTheArts.org.



Caring for that special part of your family!

Ashton S. Kane, DVM

Katie Velez, DVM

670 Park Avenue, Suite A

Keene, NH

603.357.0123

westside-vet.com

Hours:

Mon: 8:30 a.m. - 7 p.m.

Tue-Fri: 8:30 a.m. - 5:30 p.m.

Sat: 8:30 a.m. - 12:30 p.m.

Established 2007



**MEET PEOPLE.
DO STUFF.**

**WE MAKE IT EASY TO
MAKE NEW FRIENDS.**



@KEENEYPN

NOTABLE PERFORMANCES THROUGH THE YEARS

GREGG ALLMAN

AMERICA

JOAN ARMATRADING

PAT BENATAR

CLINT BLACK

BLUES TRAVELER

CHRIS BOTTI

LUKE BRYAN

MARY CHAPIN CARPENTER

THE CHIEFTANS

BRUCE COCKBURN

JUDY COLLINS

DAVID COPPERFIELD

ROBERT CRAY

DARK STAR ORCHESTRA

BO DIDDLEY

AMELIA EARHART

JONATHAN EDWARDS

MELISSA ETHERIDGE

BELA FLECK

NANCY GRIFFITH

ARLO GUTHRIE

JOHN LEE HOOKER

BRUCE HORNSBY

HOT TUNA

INDIGO GIRLS

BB KING

THE KINGSTON TRIO

KRIS KRISTOFFERSON

GORDON LIGHTFOOT

LITTLE FEAT

LYLE LOVETT

MANHATTAN TRANSFER

MARTHA GRAHAM DANCE

PAT METHENY

BOB NEUHWART

NH SYMPHONY

PHISH

POSTMODERN JUKEBOX

GRACE POTTER

JOHN PRINE

BONNIE RAITT

SECOND CITY

MARTIN SEXTON

JAKE SHIMABUKURO

TROMBONE SHORTY

RICKY SKAGGS

SWEET HONEY IN THE ROCK

LILY TOMLIN

TWIDDLE

VIENNA CHOIR BOYS

DIONNE WARWICK

THONTON WILDER

GEORGE WINSTON

BUCKWHEAT ZYDECO





Build trust.
Build community.
Build partnerships.

At DEW, we care about the quality of our work, our people, and the partnerships we build.



**BUILDING
WHAT
MATTERS
MOST**

Keene, NH
Manchester, NH
Williston, VT
Portland, ME
DEWconstruction.com



**GARY JACKSON
HEATING SERVICES LLC**

Bringing comfort to your family and home.



PROFESSIONAL, FRIENDLY, AND RELIABLE SERVICE!

Oil & Propane Heating System Design

MITSUBISHI ELECTRIC
COOLING & HEATING
Mini-Split Systems

Water Heater Replacement

Oil Tank Replacement

Air Conditioning

Installation & Maintenance

HERE FOR YOU 24 HOURS A DAY, 7 DAYS A WEEK



152 Davis Street, #3 Keene, NH • 603-352-6900

www.garyjacksonheatingservices.com



MITSUBISHI ELECTRIC
COOLING & HEATING

The Right System For You

Whether you have a single uncomfortable room, you're renovating your entire house, or you're building a home from scratch, Mitsubishi Electric has a Zoned Comfort Solution™ that fits your unique needs. Because our systems focus on individual living spaces rather than treating every room the same, it's more customizable, more energy efficient and easier to install.

www.mitsubishicomfort.com



Join our team and help the world see the unseen



From the vast expanse of space to the depths of the ocean, and into the everyday technology at your fingertips, our team at our facility in Keene, New Hampshire, harnesses the power of material science to invent life-changing technologies. It is this dedication, along with our team's expertise in science and manufacturing, that has enabled us to tackle some of the world's toughest optical challenges.

Why Join Us? Innovation, collaboration, and growth.

Dive into the world of aerospace and defense and help us invent the next generation of technologies at www.corning.com/careers.

CORNING

© 2024 Corning Incorporated. All Rights Reserved.

Get to know HCS!

Helping You Recover at Home

- Nursing
- Rehabilitation Therapies
- Meals on Wheels



Hospice Care

Comfort, care & support at end of life

- Nursing
- Pain & symptom management
- Bereavement Support

**Home Healthcare
Hospice &
Community Services**

Serving Southwestern New Hampshire
603-352-2253 • HCSservices.org

THEATRE VOCAB

CROSSOVER

A route leading from one side of the stage to the other, out of the audience's view. (Ever wonder how someone could exit the stage on one side and appear on the other?)

DARK

A time when the theatre is not open to the public. At The Colonial, this can mean being closed for a private event, rehearsal, or maintenance; typically, there are less than 20 dark dates per calendar year at The Colonial.

FOLLOW SPOT

Usually, a powerful profile lantern that is mounted in or above the auditorium used with an operator so that the light beam can be moved around the stage to follow an actor.

DOWNSTAGE

The part of the stage nearest to the audience, or a movement towards the audience.

FLY

The action of lifting an item, like scenery, up (out) or down (in) when attached to the flying system.

GAFF TAPE

Ubiquitous, sticky, fabric-backed tape. Most common widths are 0.5" for marking out areas and 2" (usually black) for everything else. Used for temporarily securing almost anything. Originally known as Gaffer's Tape, from the Gaffer (Master Electrician) on a film set.

HANG

The "hang" or "pre-hang" is a lighting/rigging session – the time when the lighting equipment is hung for a specific performance.

ORCHESTRA

Seating area consisting of the entire downstairs at The Colonial Theatre.

PIT

Short for ORCHESTRA PIT. The area housing the orchestra or band. Originally, a lower section between the front of the stage and the audience, although now describes any area around the stage housing the musicians. For select performances, the pit at The Colonial Theatre contains additional seating.

THRUST

Form of stage which projects into the auditorium beyond the proscenium. For select performances at The Colonial, the thrust is added to the stage, bringing the performers and the audiences even closer together.

UPSTAGE

The part of the stage furthest from the audience.

WINGS

The out-of-view areas to the sides of the acting area.

SIGHT LINES

A series of lines drawn on to show how much of the stage can be seen by the extreme seating positions in the auditorium. Often marked in the wings as a guide to the actors and crew.

FRESNEL

(pronounced 'Fre-nell') A type of stage light which produces an even, soft-edged beam of light through a Fresnel lens. The lens is a series of stepped concentric circles on the front and pebbled on the back and is named after its French inventor, Augustin Jean Fresnel (1788-1827). He developed the lens for French lighthouses so that they could be seen further out to sea and could achieve a longer focal length with a lot less glass than a standard lens.

RIDER/TECHNICAL RIDER

Information sent to a venue by a touring group detailing lighting, sound, staging and dressing room requirements. Ideally arrives before the performer!!

GHOST LIGHT

A light left burning overnight on stage to keep friendly spirits illuminated and unfriendly spirits at bay. Also believed to keep the theatrical muse in a 'dark' theatre, and to stop people tripping over bits of scenery when they come into the theatre in the morning.



Hannah Grimes Gallery features an exquisite juried selection of fine art from over 60 New England painters, sculptors, woodworkers, glassblowers, and fabric artists.

Visit hannahgrimesgallery.com for hours and more information.



HANNAH
GRIMES
GALLERY



42 Main Street | Keene | 603.352.6862
hannahgrimesgallery.com



The Insurance — —SOURCE inc.

The source for all your insurance needs



*Celebrating 40 Years of Serving
Family, Friends, and Neighbors
in the Monadnock Region!*

For 40 years The Insurance Source has been a family-owned and operated local insurance agency providing personal and business insurance. When you call us, you will always have a live person answering your call. No need to struggle through numerous prompts; that's the level of service we still provide.

603 357-2219 • 82 Court Street, Keene
Insurancesource.com

LIFE SAFETY FIRE PROTECTION

powered by **encore**

More than 32 years of
protecting lives and property

24-HOUR EMERGENCY SERVICE



- Fire Suppression Inspections/Service
- Fire Pump Testing/Service
- Fire Suppression Installations
- Sprinkler and Domestic Backflow Testing
- Emergency Lighting Inspections/Service
- Backflow Repairs
- Sprinkler System Installations
- Fire Extinguisher Inspections Service
- Sprinkler System Designs
- Fire Extinguisher Sales
- Sprinkler System Inspections/Service

Servicing NH, VT, MA, ME

Toll-Free 877-433-3300

MAIN OFFICE
97 Lower Jaffrey Road
Dublin, NH 03444

SEACOAST OFFICE
3 Main Street
Dover, NH 03820

www.lifesafetyfire.com



Remain in your home with
help from CVAH volunteers.

Know someone age 50+ who can use help
with transportation and minor home
chores or projects?

Cheshire Village at Home helps
members stay independent and
socially connected, all with a single call.

Reach us at (603) 903-9680

CVAH is a program of the Keene Senior Center



The **Keene Senior Center** is a meeting
and activity spot for people over 50.
Come see what we're about!

thekeeneseniorcenter.org • 312 Marlboro St. #100

More than a REALTOR®

Someone you'll remember



Nancy Thompson

Cell (603) 355-6819

nancy@nancythompson.com

**Better
Homes
and Gardens.**
REAL ESTATE

**THE
MASIELLO
GROUP**

www.NancyThompson.Masiello.com

Office: (603)352-5433

PETERBOROUGH PLAYERS

PROFESSIONAL THEATRE • EST. 1933



"American summer repertory theater at its most accomplished"
Terry Teachout, The Wall Street Journal

55 Hadley Road, Peterborough, NH 03458

www.peterboroughplayers.org



(603) 924-7585

BOX OFFICE INFORMATION

All ticket sales are final:
no refunds or exchanges.

For group sales, contact the Box Office at 603-352-2033 or boxoffice@thecolonial.org

TO BUY TICKETS...

IN PERSON

95 Main Street, Keene, NH
Tuesday-Friday 12pm-5pm

As well as two hours before live performances and one hour before film.

ONLINE

TheColonial.org
Convenience fees apply.

BY PHONE

603-352-2033
Convenience fees apply.

HISTORIC PRESERVATION FEE

A \$3.00 Historic Preservation Fee is included in the price of each ticket. This fee helps fund the long-term maintenance, restoration and improvement of our historic theatre. The Colonial Theatre is listed on the New Hampshire State Register of Historic Places and in the League of Historic American Theatres.

ACCESSIBILITY

The Colonial Performing Arts Center welcomes anyone who wants to share in the theatre's experience. Integrated and dispersed accessible seating is available for patrons with disabilities, their family and friends. These seats may be purchased online at thecolonial.org or by contacting our Box Office.

Assistive Listening Devices are available at the Box Office. Please contact us at 603-352-2033 to discuss individual accessibility requests.

HOUSE POLICIES

Late-comers may not be seated until an appropriate break in the program, at the discretion of the house manager.

Everyone attending a performance must have a ticket, including children and babies.

By attending this event you hereby consent to having your photo posted publicly for use in Colonial materials. Please note that some events have noise levels, fog or mature content that may not be appropriate for all audiences.

Photography and recording of any kind is not permitted.

CELL PHONES

For the consideration of the performers and the audience, please silence all mobile devices during the performance.

EMERGENCY EVACUATIONS

In the unlikely event of an emergency, please quickly and calmly follow Colonial personnel outside. You will be guided to one of three meeting points.

Please do not re-enter the Theatre for any reason until instructed to do so by Colonial personnel or Keene Fire/Police Departments.

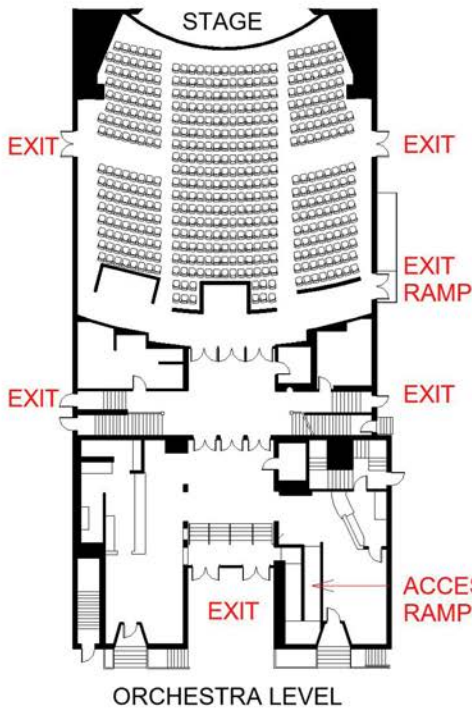

ORCHESTRA LEVEL

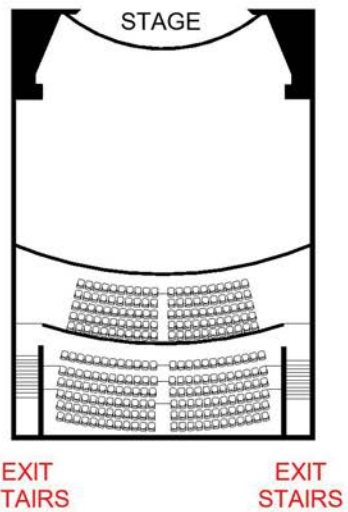

MEZZANINE / BALCONY LEVEL

BUY YOUR TICKETS THROUGH THE COLONIAL

Over the last several years, we've seen third-party websites **RESELLING** our tickets for **HUNDREDS OF DOLLARS!** While these tickets are usually valid, they're almost always significantly more expensive than by purchasing through the venue.

What to look for:

1. Make sure you're on the venue's website (ours is thecolonial.org).
2. Know your seats! If the website you're on is giving you a seat in a range (instead of specific seat numbers) you're probably not in the right place.
3. Did your ticket fees suddenly go up? Most small venues have modest service fees (ours are only \$5.50).
4. When/how will you get the tickets? Venues will give you the option to email your tickets right away, hold your tickets at 'will call', or mail them if there's enough time. If the website you are on says it will email you the tickets later... you're probably on a 3rd party site.
5. Check your email confirmation: it should be from the venue, with the venue's logo and contact information.

INDEX OF ADVERTISERS

Adventure Limousine & Transportation.....	13	Frazier and Son's Furniture.....	41	Modestman Brewing.....	38
AMT Productions.....	44	Gary Jackson Heating.....	57	Monadnock Food Co-Op.....	46
Antioch University.....	50	Granita Enoteca.....	40	Monadnock Ford.....	39
Apple Hill Center for Chamber Music.....	21	GT Donaghue Construction.....	12	Monadnock Music.....	50
Arts Alive.....	39	Guyer & Sons Roofing.....	26	MONIFF.....	40
Badger Balm.....	20	Hambwiel Electrical.....	30	Nancy Thompson Real Estate Agent.....	60
Brattleboro Auto Mall.....	48	Hannah Grimes Marketplace.....	59	NBT Bank.....	30
C&S Wholesale.....	C111	Harrisville Designs.....	10	NH Trust.....	46
Cheshire Health Foundation.....	38	HCS Services.....	57	NHDI.....	46
Cheshire Medical Center.....	44	HKS Realty.....	35	Norm's Ski & Bike Shop.....	10
Chesterfield School Foundation.....	47	Howard's Leather.....	20	Peterborough Players.....	61
Clark Mortenson.....	9	Indian King Framery.....	25	Powers Guaranteed.....	38
C.M. Minkler Paving & Painting.....	47	Insurance Source.....	60	R&R Oil Tanks.....	35
Cohen Center for Holocaust & Genocide Studies.....	34	kcs Architects.....	20	Raynor Dental.....	38
Corning.....	57	K.E. Bergeron.....	C11	REMAX.....	40
Covenant Living of Keene.....	CIV	Keene Pride.....	11	Silk Mill.....	12
DEW Construction.....	57	The Keene Senior Center.....	60	Silver Direct.....	29
Douglas Co. Inc.....	28	The Keene Sentinel.....	4-5	Steelman Production Services.....	19
Dublin Health & Benefits Group LLC.....	30	Keene Young Professionals.....	55	Syd's Carpet & Snooze Room.....	49
Dublin School.....	45	Korvin Appliance.....	21	Toadstool Bookshops.....	32
Elegant Settings.....	28	Kurn Hattin Homes.....	44	Trinity Christian School.....	15
Fenton Family Dealerships.....	45	LaPêche Lingerie.....	41	The Vacuum Store.....	44
Fieldstone.....	50	Life Safety Fire Protection.....	60	Westside Animal Hospital.....	55
Franklin Pierce University.....	41	Millwork Master.....	14		
		MOCO Arts.....	14		



PHOTO CREDIT TO JEFFREY NEWCOMER

COLONIAL PERFORMING ARTS CENTER

OUR PATRONS ARE YOUR CUSTOMERS

Arts & culture events drive local spending! When an individual comes to the Monadnock region to see a show or attend an event, they spend an average of \$31.64 on other things in the community - from food to lodging, gas and souvenirs.

Increase your customer base with your advertising message here.

Call 603-357-1233 to find out about advertising in our next program

Striking the right chord

No matter where we spend our day — from our distribution centers to our offices — we help feed our families, neighbors and communities. We keep our values alive through a culture that embraces differences, promotes innovation and is focused on giving back.

It's more than a job. It's a legacy.

C&S is a proud sponsor of The Colonial Theatre.



7 Corporate Drive | Keene, NH
www.cswg.com





Fill your future *with promise.*

Discover the ideal environment for staying active, engaged and living life to the fullest, with the added security of Lifecare—healthcare for life. Call **1-877-313-2542** or visit **CovLivingKeene.org** to learn more.

covenant  living
of KEENE

95 Wyman Road, Keene, NH 03431



Covenant Living Communities & Services does not discriminate pursuant to the Federal Fair Housing Act.